

AS-MCP2-IP67 Installation instructions

1. Carefully knock out the holes for the Cables glands, or conduit, required for the installation. Fix Waterproof Back Box to wall using screws through the pre-drilled holes.
Note: Do NOT make additional holes in the waterproof cavity.

2. Insert the "O" Ring into the Red section of the Call Point as shown in Figure 1 below.

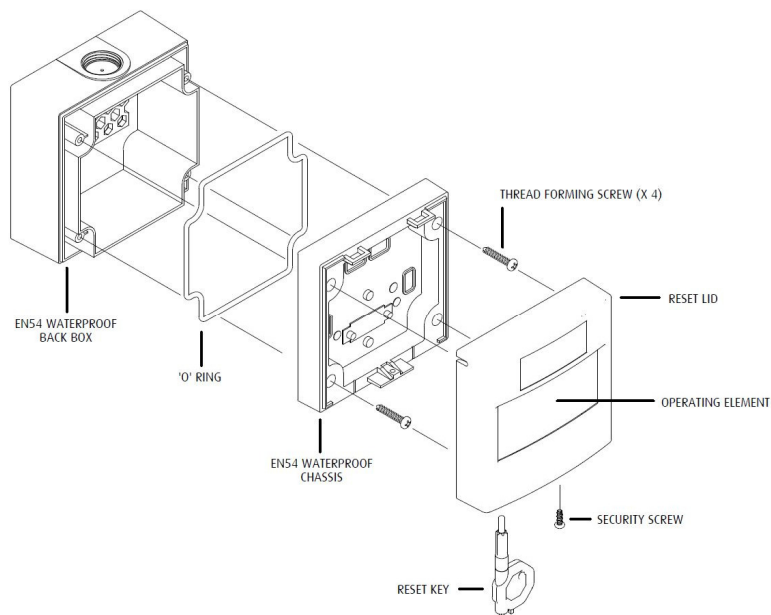

Figure 1

3. Set the device address using the 8-Way DIL switch on the reverse of the Unit.

4. Make the Loop connections as shown in figure 2 below and on the product Label. An Earth point is provided in the Back Box moulding if required.

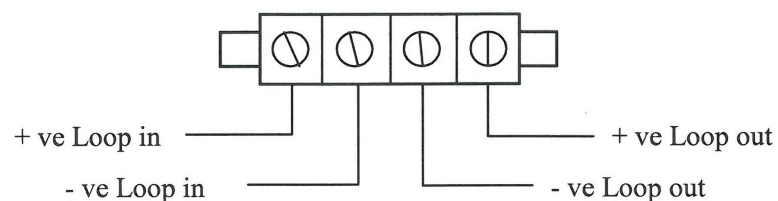

Figure 2

AS-MCP2-IP67 Installation instructions

5. Fasten the Waterproof Chassis to the Back Box, then fit the Reset Lid to the unit, as shown in Figure 1, using the screws provided.

6. To Activate the Call Point, Press the Operating Face, where indicated by the arrows, until it Clicks and the Yellow/Black flag is clearly visible.

7. To Reset the Call Point, Insert the Reset Key where shown in Figure 1 and turn anti-clockwise until it Clicks and the Yellow/Black flag has retracted from view.

AS-MCP2-IP67 - Waterproof Resettable Manual Call Point



NITTAN

Nittan Europe Ltd. Tel: +44 (0) 1483 769 555
Hiple Street, Fax: +44 (0) 1483 756 686
Old Woking, Email: sales@nittan.co.uk
Surrey, GU22 9LQ Web: www.nittan.co.uk
United Kingdom

EN54-11: 2011 - Type A Indoor Manual Call Point IP67

For use with Nittan Sensortec Protocol Only.
Loop Voltage: 16 to 28 V d.c.
Quiescent Current: 300µA
Alarm Current: 3mA (LED ON).
Ingress Protection: IP67
Mass: 280g

Technical Data Sheet: TD-AS-MCP2-IP67